

MEZZANINE LEVEL PLAN:

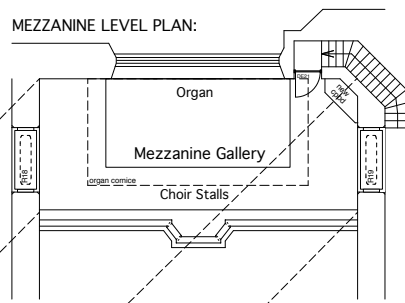

GROUND FLOOR PLAN:

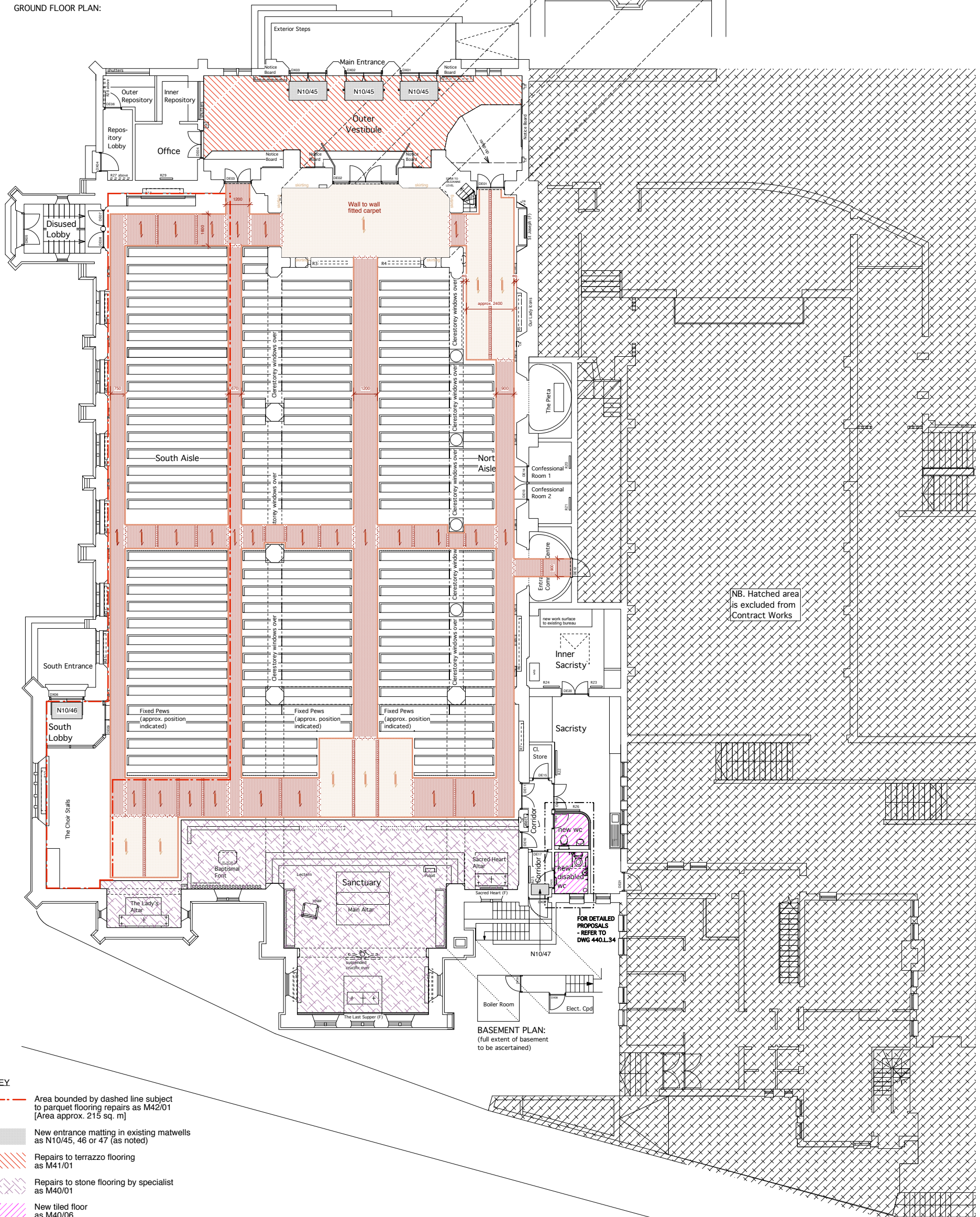

BASEMENT PLAN:  
(full extent of basement  
to be ascertained)

- KEY**
- - - Area bounded by dashed line subject to parquet flooring repairs as M42/01 [Area approx. 215 sq. m]
  - New entrance matting in existing matwells as N10/45, 46 or 47 (as noted)
  - Repairs to terrazzo flooring as M41/01
  - Repairs to stone flooring by specialist as M40/01
  - New tiled floor as M40/06
  - New carpet flooring as M50/25 Colour A - tbc
  - New carpet flooring as M50/25 Colour B - tbc
  - Overlocking edge as M50/25
  - Threshold trim as M50/70
  - Off site butt joint as M50/25
  - On site butt joint as M50/25
  - Direction of weave colour stripe in flooring M50/25

**NOTES:**

1. This drawing is based upon previous design plan drawings and is not based upon a complete measured survey of the existing building. Any discrepancies identified between this plan drawing and the as-built building fabric should be brought to the Architect's attention.
2. Setting out of carpet is indicative of design intent. Precise setting out to be confirmed on site ahead of manufacture and installation.

Revisions C0 - 27/04/12 - Issued for Construction.

Title Sacred Heart Catholic Church, Queex Road, London NW6  
**PLAN: Proposed Flooring Schematic**

**Brady Mallalieu Architects**  
90 Queens Drive, London N4 2HW

Scale 1:100/A1  
1:200/A3  
Date November 11  
Drawing No. **440.L.028** rev. C0

T +44 (0)20 8880 1544  
F +44 (0)20 8880 2687  
bma@bradymallalieu.com

All dimensions to be checked on site. Do not scale off this drawing. This drawing is copyright.